

This school building dates back to the beginning of the last century and is under the control of the Italian Monuments and Fine Arts Dept. It is located next to the church of St. Marco in one of the oldest squares of the historic Brera area in the center of Milan. The fine façade has begun to show signs of wear and tear and the inside is no longer adequate for the requirements of the students. The building is on four floors which house the classrooms, as well as a basement used for storing documents and relevant technology. In the center is the old courtyard which sets the stage for the school life. The aim of the project, from the architectural point of view, begins with the restoration of the property's main façade where there is an important access stairway in natural stone, as well as functional planning inside the building. There are also plans to restore the main hall, the library and the science laboratory. The project includes updating the safety measures with particular attention to the electric wiring, cables, alarms and fire protection.

**WORK CARRIED OUT**  
control of the conformity to the laws in force; Renovation design; direction works, security coordination

**PROGRAM**  
school built at the beginning of 20th century in the centre of Milan. Listed building according to the Italian Society for the Conservation of Historic Buildings.

**PROJECT**  
SD Partners

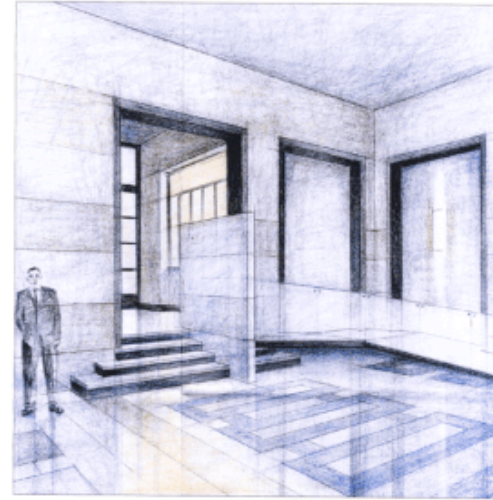

**CORRIDOI E PERCORSI INTERNI**  
L'adattamento di percorsi e servizi scale per l'accessibilità nella barriera architettonica.



**AULA MAGNA**  
Progetto di illuminazione delle sale in 3D (loggi e nuova strutturazione delle pareti).

## Parini Hight School milan 1999-2002

**PROJECT SITE**  
Milan downtown

**CLIENT**  
Milan Province Government

**COST**  
2.234.000,00 euros

**GROSS FLOOR AREA**  
8.000 sqm

**STATUS**  
built, 1999-2002

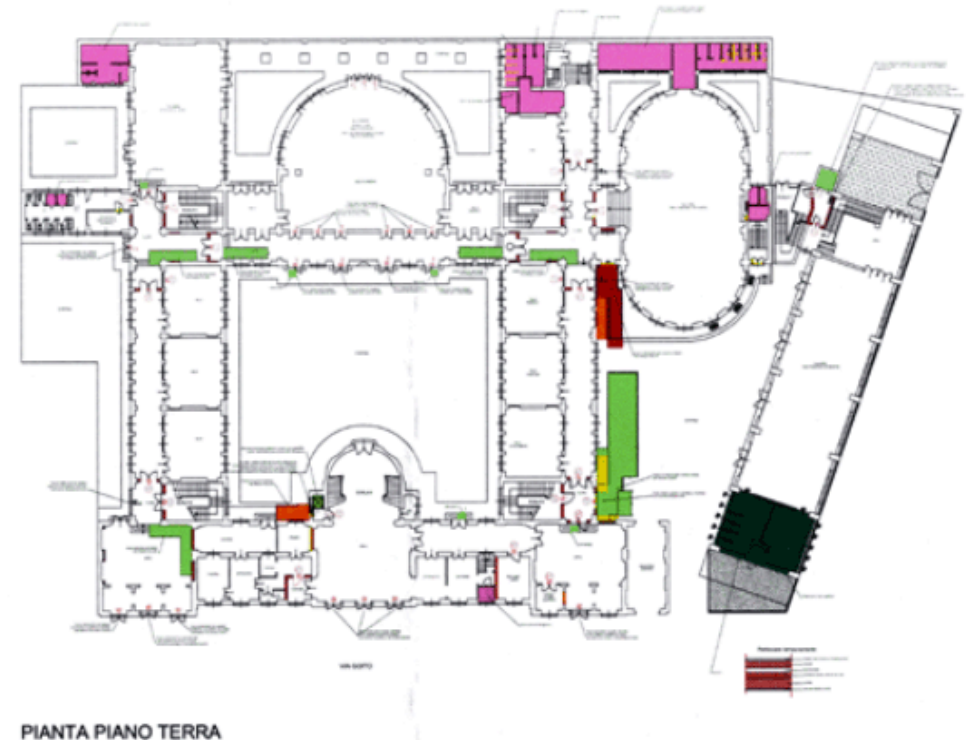

**PIANTA PIANO TERRA**